

Star Trans

Transforming Technology



SINGLE - PHASE TRANSFORMERS



SWIMMING POOL TRANSFORMERS

SAFETY FOR SWIMMING-POOL TRANSFORMER



Safety isolating transformer
to: VDE 0570 Teil 2-6, DIN EN 61558-2-6, EN 61558-2-6, IEC 61558-2-6, UL
5085-1/-2, CSA 22.2 No.66

General Data

Rated input voltage 230 V AC
Rated output voltage 12 V AC
Rated power 350 VA
Insulation class I H
Maximum ambient temperature 50 °C
Efficiency up to 98%
Degree of protection IP20
Frequency 50/60 hz

Advantages

Input voltages 230 VAC
Very good switch-on behaviour thanks to reduced starting currents
High performance for the volume thanks to compact design
Very good corrosion protection and low noise thanks to vacuum

Applications

Single-phase safety transformers intended to supply spotlights in swimming-pools, garden ponds, ornamental fountains and moist locations, where for safety reasons it is necessary to supply with safety extra low voltage (SELV).

It has several taps in the primary winding in order to compensate for the voltage drop in the transformer-spotlight line conductors and thus gets an adequate brightness in every spotlight. On request we can manufacture transformers with other rated power or voltages, or with other line lengths between transformers and spotlights.

Sample application

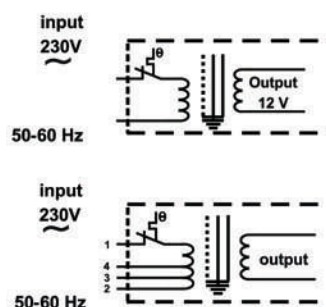

Approvals

UL 5085-1/-2, CSA 22.2 No.66



SAFETY FOR SWIMMING-POOL TRANSFORMER

30	Mechanical data	Typ	Terminals	Fixing method	Fixing screws	Weight	Dimension picture (in mm)	A	B	C						
		SW03500167	Screw -type terminals	Base plate	M4	8.350kg	1	237	140	125						
		SW03500168	Screw -type terminals	Base plate	M4	8.950 kg	1	237	140	125						

Dimension pictures

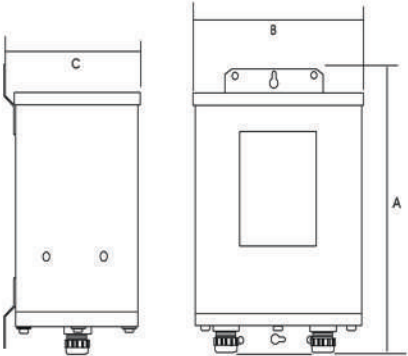

SAFETY FOR SWIMMING-POOL TRANSFORMER

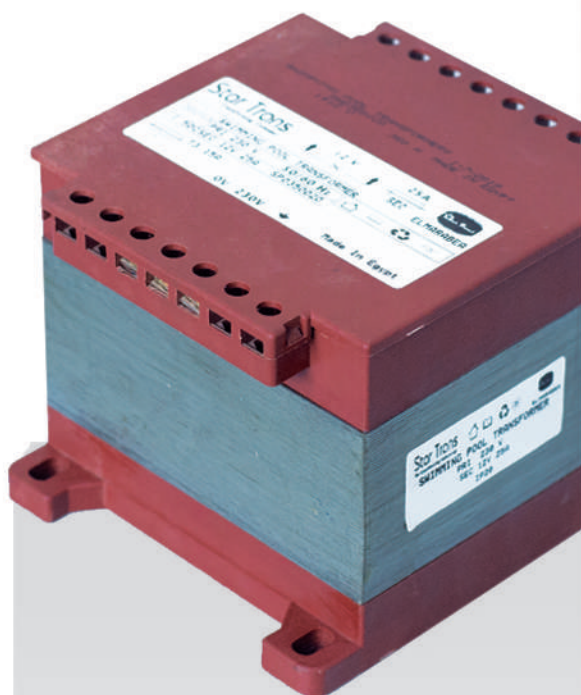

Safety isolating transformer
to: VDE 0570 Teil 2-6, DIN EN 61558-2-6, EN 61558-2-6, IEC 61558-2-6, UL 5085-1/-2, CSA 22.2 No.66

General Data

Rated input voltage 230 V AC
Rated output voltage 12 V AC
Rated power 130VA - 350 VA
Insulation class I H
Maximum ambient temperature 50 °C
Efficiency up to 98%
Degree of protection IP20
Frequency 50/60 hz

Advantages

Input voltages 230 VAC
Very good switch-on behaviour thanks to reduced starting currents
High performance for the volume thanks to compact design
Very good corrosion protection and low noise thanks to vacuum

Applications

Single-phase safety transformers intended to supply spotlights in swimming-pools, garden ponds, ornamental fountains and moist locations, where for safety reasons it is necessary to supply with safety extra low voltage (SELV).

It has several taps in the primary winding in order to compensate for the voltage drop in the transformer-spotlight line conductors and thus gets an adequate brightness in every spotlight. On request we can manufacture transformers with other rated power or voltages, or with other line lengths between transformers and spotlights.

Sample application

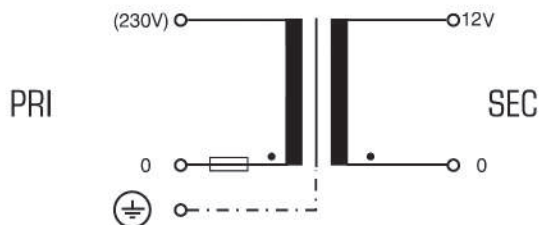

Approvals

UL 5085-1/-2, CSA 22.2 No.66



SAFETY FOR SWIMMING-POOL TRANSFORMER

Mechanical data	Typ	Terminals	Fixing method	Fixing screws	Weight	Dimension picture (in mm)	A	B	C	D	E	F
	SW0130-20-00	Screw -type terminals	Base plate	M4	1 kg		76.2	76.2	76.2	76.2	76.2	4.8
	CT0350-20 -00	Screw -type terminals	Base plate	M4	1.4 kg		76.2	76.2	76.2	76.2	76.2	4.8

Dimension pictures

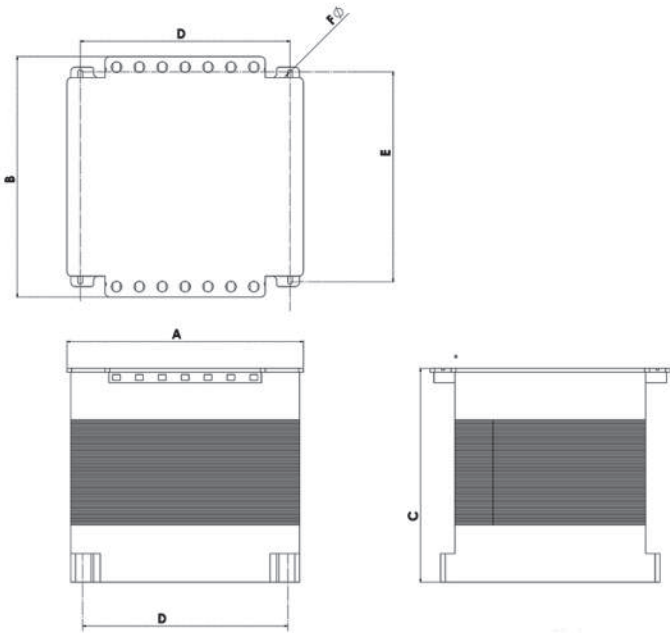

SAFETY FOR SWIMMING-POOL TRANSFORMER

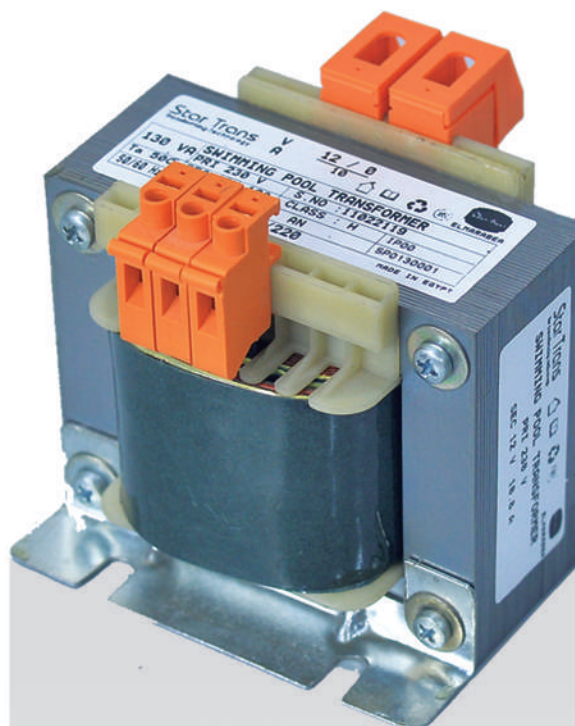

Safety isolating transformer
to: VDE 0570 Teil 2-6, DIN EN 61558-2-6, EN 61558-2-6, IEC 61558-2-6, UL
5085-1/-2, CSA 22.2 No.66

General Data

Rated input voltage 230 V AC
Rated output voltage 12 V AC
Rated power 130VA - 350 VA
Insulation class H
Maximum ambient temperature 50 °C
Efficiency up to 98%
Degree of protection IP00
Frequency 50/60 hz

Advantages

Input voltages 230 VAC
Very good switch-on behaviour thanks to reduced starting currents
High performance for the volume thanks to compact design
Very good corrosion protection and low noise thanks to vacuum

Applications

Single-phase safety transformers intended to supply spotlights in swimming-pools, garden ponds, ornamental fountains and moist locations, where for safety reasons it is necessary to supply with safety extra low voltage (SELV).

It has several taps in the primary winding in order to compensate for the voltage drop in the transformer-spotlight line conductors and thus gets an adequate brightness in every spotlight. On request we can manufacture transformers with other rated power or voltages, or with other line lengths between transformers and spotlights.

Sample application

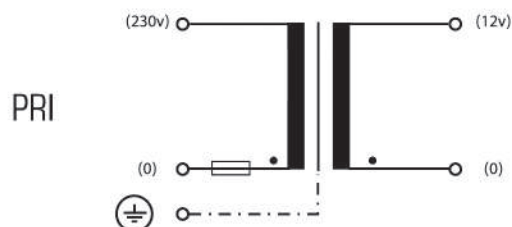

Approvals

UL 5085-1/-2, CSA 22.2 No.66



SAFETY FOR SWIMMING-POOL TRANSFORMER

Mechanical data	Typ	Terminals	Fixing method	Fixing screws	Weight	Dimension picture (in mm)	A	B	C	D	E	F
	SP0050-00-00	Screw -type terminals	Base plate	M4	1.5 kg		76.2	63	85	42	50	5
	SP0130-00-00	Screw -type terminals	Base plate	M4	2.5 kg		96	74	100	55	58	5
	SP0350-00-00	Screw -type terminals	Base plate	M6	5.2 kg		120	100	120	75	77	6

Dimension pictures

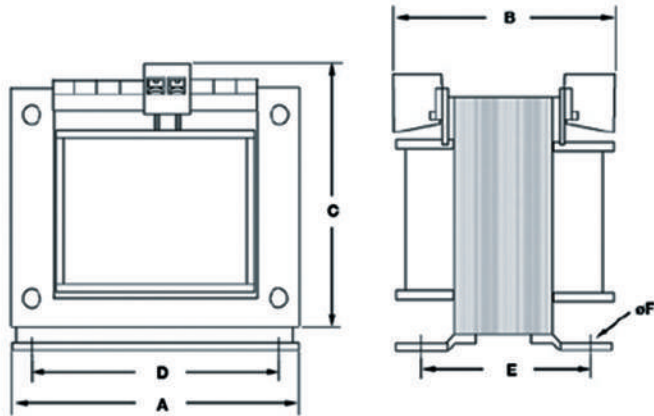

TRANSFORMER

SAFETY FOR
SWIMMING POOL
TRANSFORMER



www.startranseg.com